

**NOTES:**

1. MINIMUM STANDARD IS TWO COAT BITUMEN (FOR BOTH RESIDENTIAL AND RURAL LIVING) BUT MAY BE CONCRETE, PAVED OR MINIMUM 30mm ASPHALT FOR RESIDENTIAL.
2. EXISTING ROAD SHOWN AS 7.0m WIDE SEAL (2 x 3.5m LANES) AND KERBED.
3. 4.5m WIDE CROSSOVER SHOWN UNKERBED.

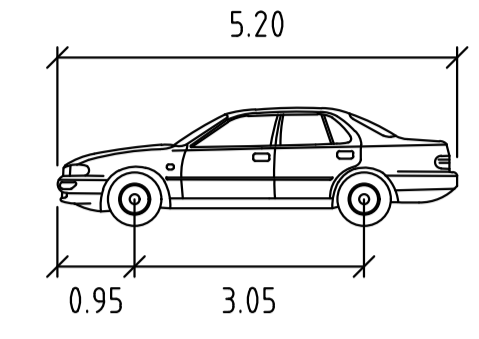
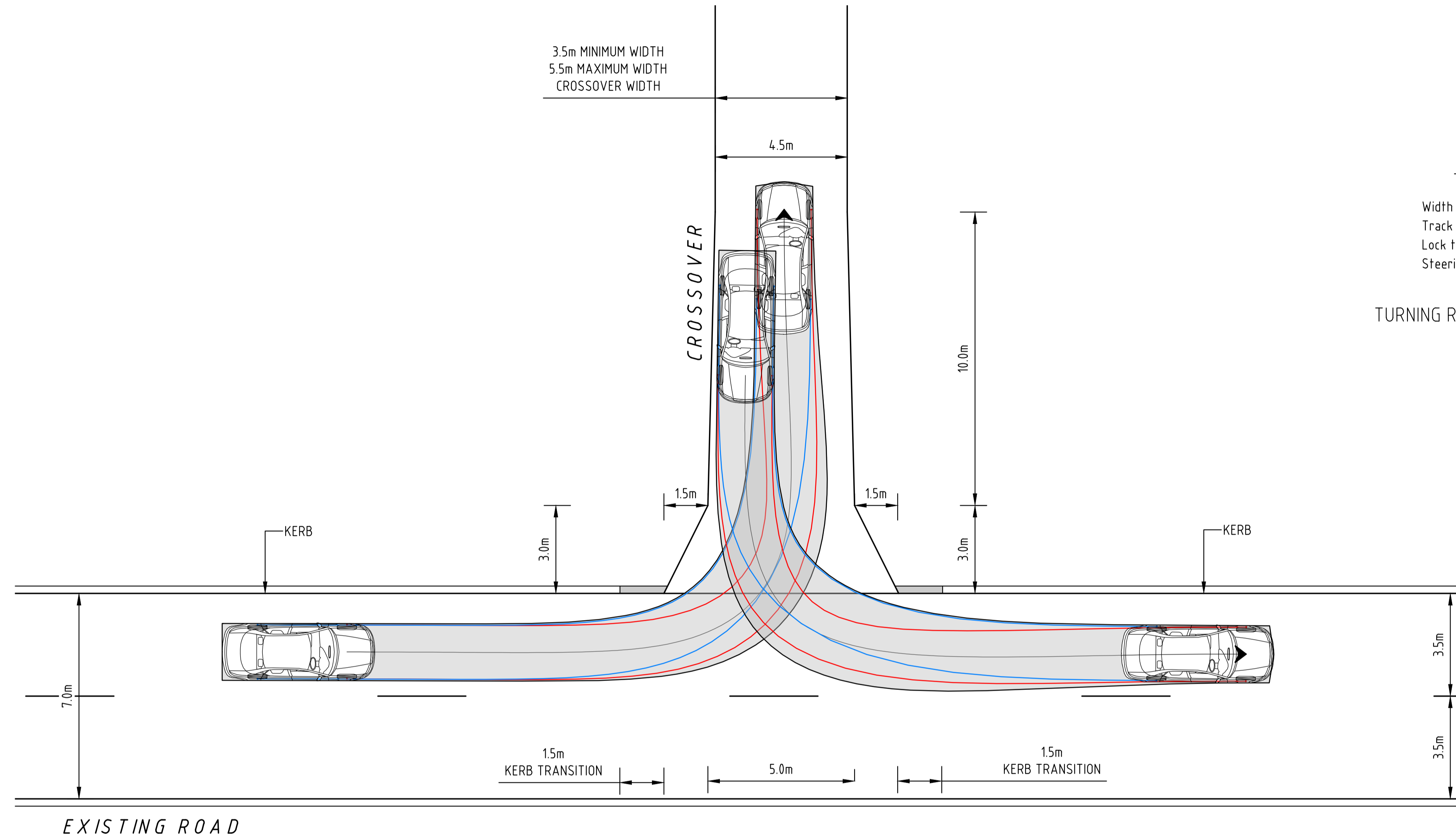

**DESIGN VEHICLE CAR**

	meters
Width	: 1.94
Track	: 1.84
Lock to Lock Time	: 6.0
Steering Angle	: 33.6

TURNING RADIUS = 8m OUTSIDE FRONT WHEEL

EXISTING ROAD

**URBAN CROSSOVER SETOUT - LIGHT VEHICLES**  
SCALE 1:100

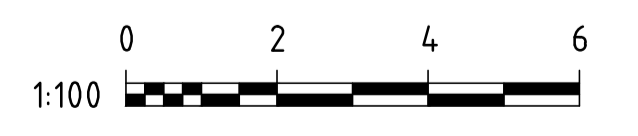

<p>PROJECT:</p> <p style="text-align: center;"><b>SHIRE OF GINGIN CROSSOVER SPECIFICATIONS</b></p>	<table border="1" style="width: 100%; border-collapse: collapse;"> <tr> <td style="width: 5%;">B</td> <td style="width: 10%;">21-1-2021</td> <td style="width: 60%;">WORD DRIVEWAY REPLACED WITH CROSSOVER IN TITLE AND DRAWING</td> <td style="width: 10%;">MJV</td> </tr> <tr> <td>A</td> <td>19-01-21</td> <td>ISSUED FOR APPROVAL</td> <td>YJW</td> </tr> <tr> <td>No.</td> <td>DATE</td> <td>REVISION</td> <td>BY</td> </tr> </table>	B	21-1-2021	WORD DRIVEWAY REPLACED WITH CROSSOVER IN TITLE AND DRAWING	MJV	A	19-01-21	ISSUED FOR APPROVAL	YJW	No.	DATE	REVISION	BY	<p><b>COPYRIGHT</b></p> <p><small>COPYRIGHT IN THIS DRAWING IS THE PROPERTY OF THE CONSULTANT. THE CLIENT HAS LICENSE TO USE THIS DRAWING FOR THE PROJECT ONLY. THE USER SHALL BE RESPONSIBLE FOR "SITE CHECKING" ALL DIMENSIONS BEFORE COMMENCEMENT OF WORK. CAD DRAWING IS NOT MANUALLY ALTER.</small></p> <p><small>ONLY PLANS WITH NUMERICAL REVISION (REV '1' OR HIGHER) AND SIGNED AS APPROVED SHALL BE USED FOR CONSTRUCTION.</small></p>	<p style="text-align: center;"><b>Porter</b> Consulting Engineers</p> <p><small>Level 2 Kishorn Court 58 Kishorn Road HQ Pleasant 6153 WA PO Box 1036 Canning Bridge 6153 WA Tel (08) 9315 9955 Email office@portereng.com.au www.portereng.com.au</small></p> <p><small>10000 Pty Ltd ACN 078 871 748 is a trustee for the Consulting Engineering Unit. Trade trading as Porter Consulting Engineers ABN 78 638 296 385.</small></p>	<p style="text-align: center;"><b>SHIRE OF GINGIN</b></p> <p style="text-align: center;">HISTORY   BEAUTY   PROSPERITY</p>	<p>DRAWING:</p> <p style="text-align: center;"><b>RESIDENTIAL &amp; RURAL LIVING URBAN CROSSOVER SETOUT LIGHT VEHICLES</b></p> <p>STATUS: <b>FOR INFORMATION</b></p>	<p>SCALE: 1:100</p> <p>DATE: JAN 2021</p> <p>DESIGN: ELW</p> <p>DRAWN: MJV</p> <p>CHECK: APPD</p>	<p>DRAWING No:</p> <p style="text-align: center;"><b>SoG/STD-11</b></p> <p>FILE NAME: S:\ACTIVE PROJECTS\20-12-1999\ACAD\2012199_SoG-STD-11.dwg</p>	<p>REV No:</p> <p style="text-align: center;"><b>B</b></p>	<p>ORIGINAL DRAWING SIZE:</p> <p style="text-align: center;"><b>A1</b></p>
B	21-1-2021	WORD DRIVEWAY REPLACED WITH CROSSOVER IN TITLE AND DRAWING	MJV																		
A	19-01-21	ISSUED FOR APPROVAL	YJW																		
No.	DATE	REVISION	BY																		