

DESIGN VEHICLE - DOUBLE ROAD TRAIN

NTS
36.00m

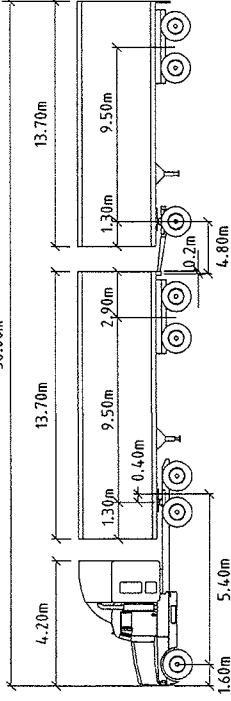

TURNING RADIUS = 15m TO OUTSIDE FRONT WHEEL

DRIVEWAY

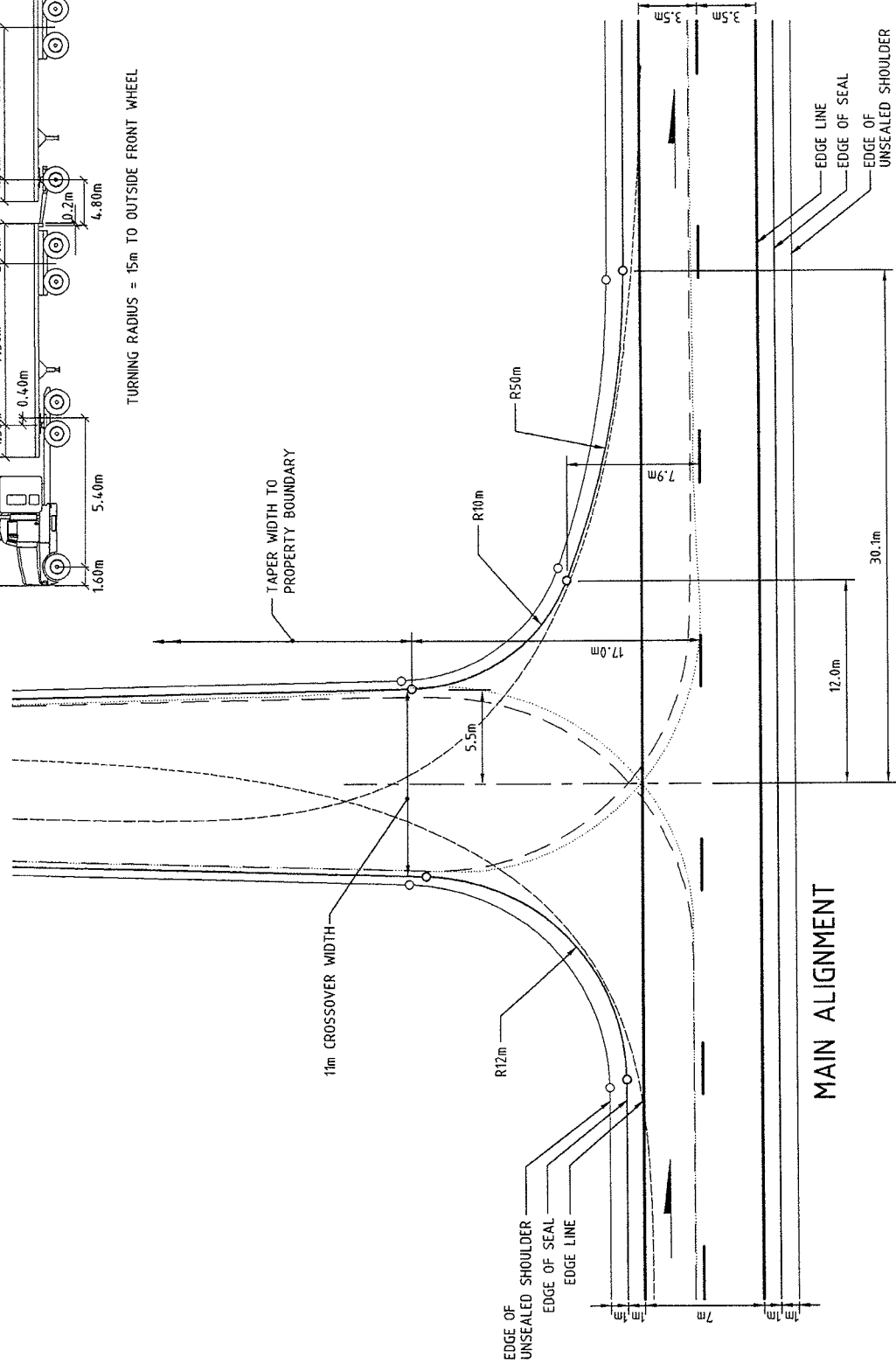

**RURAL DRIVEWAY SETOUT
DOUBLE ROAD TRAIN**

SCALE 1:250

AMENDMENTS	
NO.	DESCRIPTION
1	TITLE AMENDED TO GUIDELINE DRAWING.

APPROVED & DATE
[Signature] 9.5.06

NOTES

1. MAIN ALIGNMENT SHOWN AS 9.0m WIDE SEAL (2 x 3.5m LANES + 2 x 1.0m SEALED SHOULDERS) AND 2 x 1.0m UNSEALED SHOULDERS.
2. CROSSOVER SHOWN AS 11.0m WIDE SEAL AND 2 x 0.5m UNSEALED SHOULDERS.
3. FOR RURAL DRIVEWAY DETAILS REFER TO DRAWING 9831-6281.

LEGEND

- OUTSIDE FRONT WHEEL PATH
- - - INSIDE REAR WHEEL PATH
- PATH OF OVERHANG

METADATA

GROUND SURVEY STANDARD:
DATE OF CAPTURE:
MAPPING SURVEY STANDARD:
DATE OF CAPTURE:
MAIN ROADS PROJECT ZONE:
HEIGHT DATUM:

MAIN ROADS
Western Australia
TECHNOLOGY & ENVIRONMENT DIRECTORATE
ROAD & TRAFFIC ENGINEERING
EAST PERTH, WA
WATERLOO RESERVE
STUDIOS 2323 STN
ST-2323-3403

PROJECT NUMBER: 67-08-65
DESIGNED / DRAWN: B. SHOOK / E. FINDLATER
CHECKED: T. FREEMAN 06/05/05
APPROVED: R. GROVE 06/05/05

GUIDELINE DRAWING
RURAL DRIVEWAY SETOUT
DOUBLE ROAD TRAIN

LOCAL AUTHORITY:
DRAWING NUMBER:
AMENDMENT:
200431-0196-1